

8

Equipamiento para vestuarios

Fixtures & fittings for
locker rooms



8.1 Bancos para vestuario / Changing roob bench

8.05 Estructuras bancos para vestuario / Structures changing room bench

8.2 Herrajes para vestuarios / Changing room fittings

8.11 Herrajes para cabinas sanitarias / Toilet Partition fittings

8.15 Puerta corredera cabina sanitaria / Toilet Partition sliding door

8.18 Perfiles de aluminio para cabinas sanitarias / Aluminium profiles for toilet partition fittings

8.20 Herrajes para taquillas / Locker fittings

8.23 Complementos para taquillas / Accessories for locker

8.24 Pies para taquillas / Feet partition hardware

8.1

03/08

BANCOS PARA VESTUARIO CHANGING ROOM BENCH

8.05 Estructuras bancos para vestuario Structures changing room bench

Estructuras para bancos de vestuario realizadas en aluminio acabado plata mate, concebidos para realizarlos con tableros de fenólico de 12 / 13mm o tablero de 19mm de espesor y fijados mediante tornillos pasantes suministrados con la estructura.

Structures for changing room benches made from matt aluminium plate, designed to be used with 12 - 13 mm thick phenol board or 19mm thick board and fixed with screws provided with the structure.

- Montaje tornillos M8x80 y M8x60.
- Assembly screws M8x80 & M8x60.

- Montaje tornillos M6x25.
- Assembly screws M6x25.

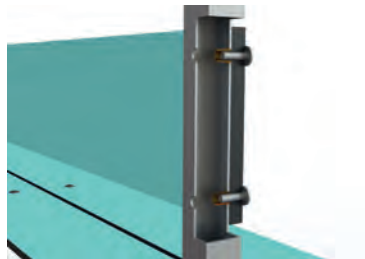



ESTRUCTURAS BANCOS PARA VESTUARIO / STRUCTURES CHANGING ROOM BENCH

Lateral banco simple

Lateral single bench

Cod.



80216	62	1
--------------	-----------	----------

Aluminio / Aluminium

Incluido en el pack:

- Incluye 4 tornillos M8x80 DIN 603
- Incluye 2 tornillos M8x60 DIN 603
- Incluye 6 tuercas M8 DIN 603

Included in the pack:

- 4 screws M8x80 DIN 603
- 2 screws M8x60 DIN 603
- 6 nuts M8 DIN 603

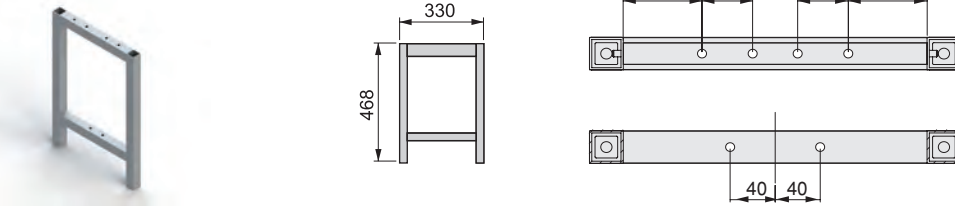

Lateral Banco simple con Perchero

Lateral of single bench with hook

Cod.



80217	62	E/I
--------------	-----------	------------

Aluminio / Aluminium

Incluido en el pack:

- Incluye 4 tornillos M8x80 DIN 603
- Incluye 2 tornillos M8x60 DIN 603
- Incluye 6 tuercas M8 DIN 603
- Incluye 4 tornillos M6x25 DIN 603

Included in the pack:

- 4 screws M8x80 DIN 603
- 2 screws M8x60 DIN 603
- 6 nuts M8 DIN 603
- 4 screws M6x25 DIN 603

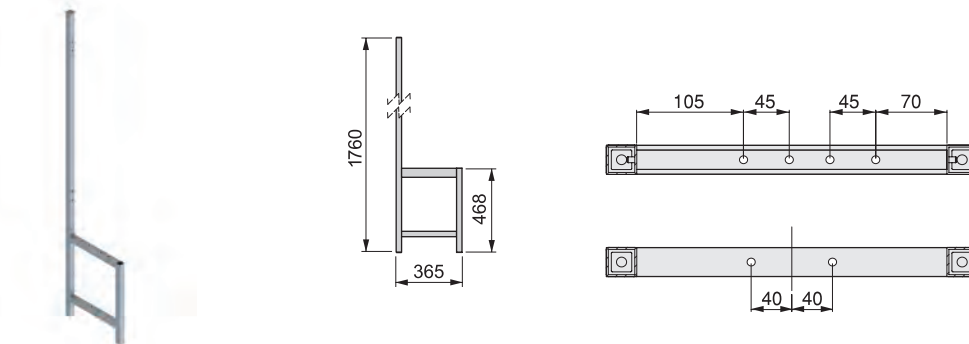

Lateral Banco simple con Perchero y Altito

Lateral of single bench with hook and top shelf

Cod.



80218	62	E/I
--------------	-----------	------------

Aluminio / Aluminium

Incluido en el pack:

- Incluye 4 tornillos M8x80 DIN 603
- Incluye 2 tornillos M8x60 DIN 603
- Incluye 6 tuercas M8 DIN 603
- Incluye 6 tornillos M6x25 DIN 603

Included in the pack:

- 4 screws M8x80 DIN 603
- 2 screws M8x60 DIN 603
- 6 nuts M8 DIN 603
- 6 screws M6x25 DIN 603

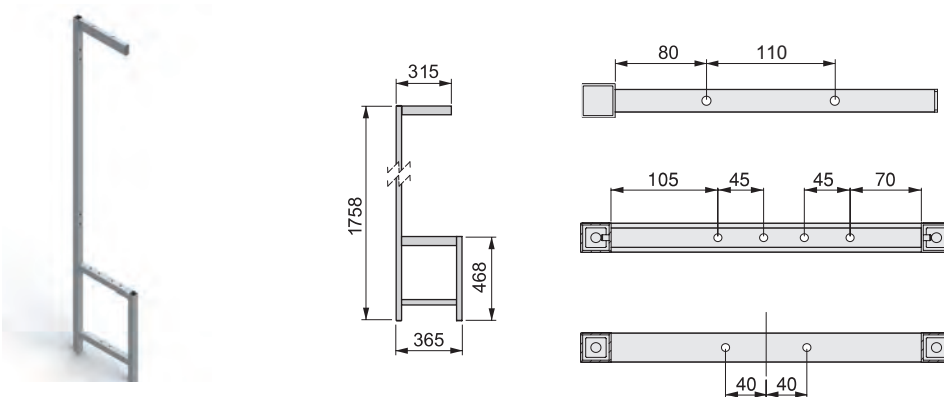

Consultar otras posibles medidas y acabados.
 Possibility of others measurements and finishes on request.

Nivelador recomendado Cod.3057464
 Leveller recommended Cod.3057464

E/I: Embalaje adaptado al pedido.
 E/I: Packaging adapted to the order.

Lateral Banco taquilla

Lateral locker bench

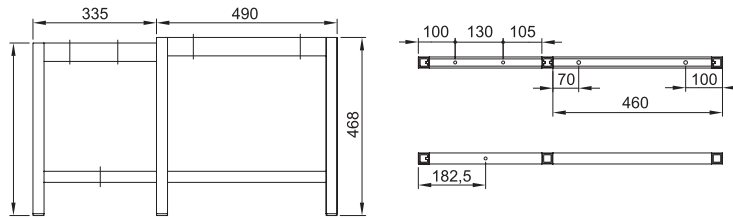

Cod.



80224 | **62** | 1

Aluminio / Aluminium

Incluido en el pack:

- Incluye 4 tornillos M8x80 DIN 603
- Incluye 1 tornillo M8x70 DIN 603
- Incluye 5 tuercas M8 DIN 603

Included in the pack:

- 4 screws M8x80 DIN 603
- 1 screw M8x60 DIN 603
- 5 nuts M8 DIN 603

Lateral Banco doble con perchero

Lateral of double bench with hook

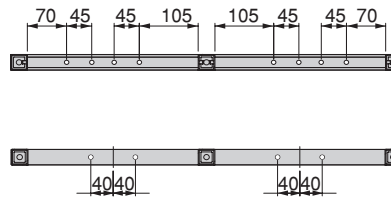
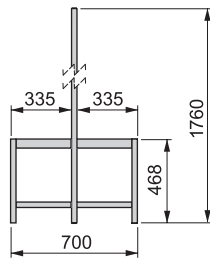

Cod.



80219 | **62** | E/I

Aluminio / Aluminium

Incluido en el pack:

- Incluye 8 tornillos M8x80 DIN 603
- Incluye 4 tornillos M8x60 DIN 603
- Incluye 12 tuercas M8 DIN 603
- Incluye 8 tornillos M6x25 DIN 603

Included in the pack:

- 8 screws M8x80 DIN 603
- 4 screws M8x60 DIN 603
- 12 nuts M8 DIN 603
- 8 screws M6x25 DIN 603

Lateral Banco doble con perchero y Altillo

Lateral of double bench with hook and top shelf

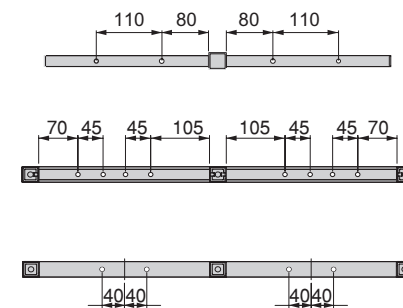
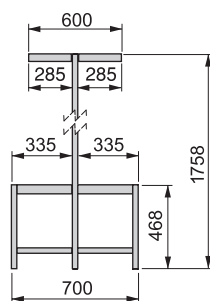

Cod.



80220 | **62** | E/I

Aluminio / Aluminium

Incluido en el pack:

- Incluye 8 tornillos M8x80 DIN 603
- Incluye 4 tornillos M8x60 DIN 603
- Incluye 12 tuercas M8 DIN 603
- Incluye 12 tornillos M6x25 DIN 603

Included in the pack:

- 8 screws M8x80 DIN 603
- 4 screws M8x60 DIN 603
- 12 nuts M8 DIN 603
- 12 screws M6x25 DIN 603

Consultar otras posibles medidas y acabados.

Possibility of others measurements and finishes on request.

Nivelador recomendado Cod.3057464

Leveller recommended Cod.3057464

E/I: Embalaje adaptado al pedido.

E/I: Packaging adapted to the order.

Colgador

Coat and Hat Hook

Cod.



85029 | **65** | 20 / 200

Acero Inx. / Stainless steel

- Incluye 2 tornillos
- Include 2 Screws

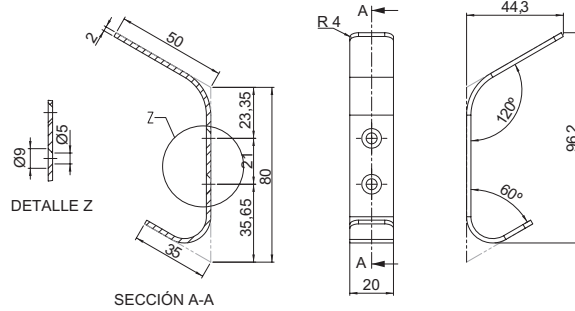

Consultar otras posibles medidas y acabados.

Possibility of others measuraments and finishes on request.

Nivelador recomendado Cod.3057464

Levellor recomendad Cod.3057464

E/I: Embalaje adaptado al pedido.

E/I: Packaging adapted to the order.



HERRAJES PARA VESTUARIO

CHANGING ROOM FITTINGS

- 8.11 Herrajes para cabinas sanitarias**
Toilet Partition fittings
- 8.15 Puerta corredera cabina sanitaria**
Toilet Partition sliding door
- 8.18 Perfiles de aluminio para cabinas sanitarias**
Aluminium profiles for toilet partition fittings
- 8.20 Herrajes para taquillas**
Locker fittings
- 8.23 Complementos para taquillas**
Accessories for locker
- 8.24 Pies para taquillas**
Feet partition hardware

Solución para la realización de baños y vestuarios de una manera rápida y sencilla. Los herrajes están realizados en Acero Inox. AISI-304 y pensados para paneles de fenólico de 12-13mm.

Solution for the layout of toilets and changing rooms in a quick and easy way. Fittings made in Stainless Steel AISI-304 and designed to be used with 12-13 mm thick phenol board.

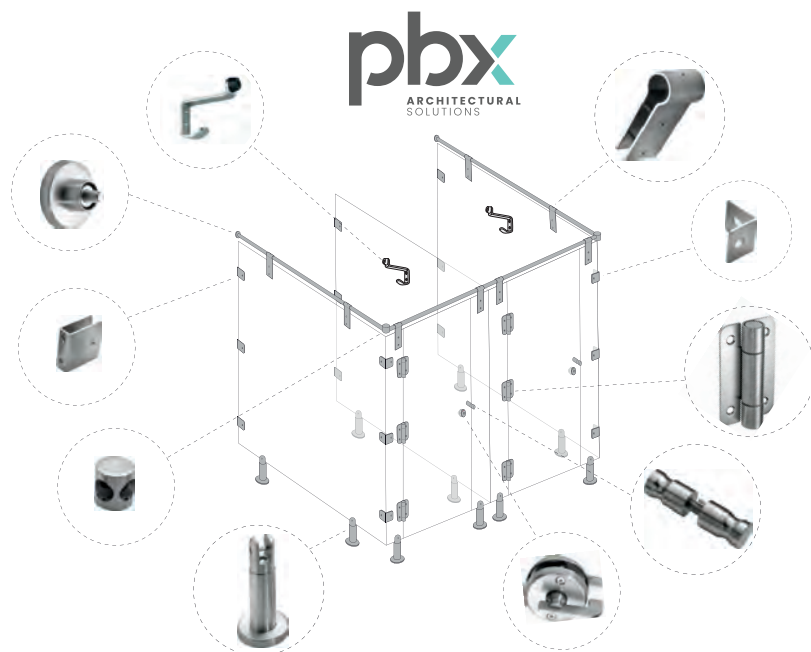



HERRAJES PARA CABINAS SANITARIAS / TOILET PARTITION FITTINGS

Pata regulable 100/180

Adjustable support leg 100/180

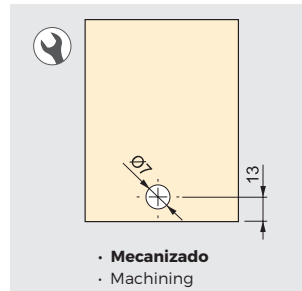

Acero. / Steel	Cod.		
AISI-304	85000	65	4 / 40
AISI-316	85018	65	4 / 40
Acero Inx. / Stainless steel			

- Incluye 3 tornillos con tacos.
- Include 3 screws with plastic anchor.

Pata regulable 210/370

Adjustable support leg 210/370

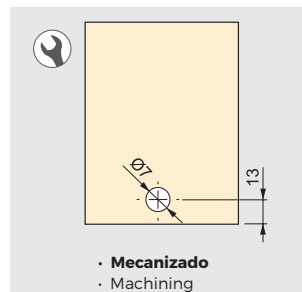

Cod.		
85025	65	3 / 24
Acero Inx. / Stainless steel		

- Incluye 3 tornillos con tacos.
- Include 3 screws with plastic anchor.

Soporte Tubo Ø25 a pared

Support tube Ø25- to wall

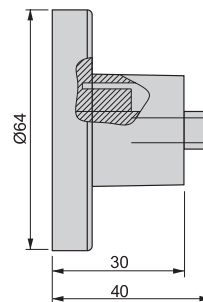

Cod.		
85001	65	10 / 60
Acero Inx. / Stainless steel		

- Incluye 3 tornillos con tacos.
- Include 3 screws with plastic anchor.

Pinza unión Tubo Ø25 a panel

Hanging clamp tube Ø25 to board

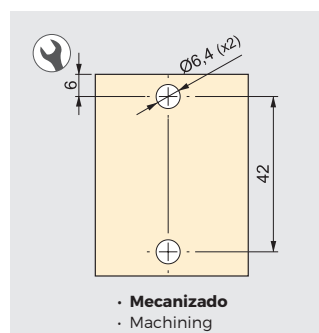
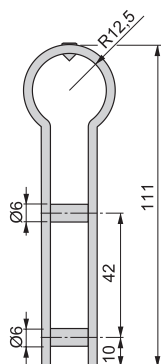

Cod.		
85002	65	10 / 60
Acero Inx. / Stainless steel		

Nudo conexión tubo Ø25

Joint connection tube Ø25

Conexión Connection	Cod.		
2-90°	85003	65	6 / 60
3-180°	85004	65	6 / 60

Acero Inx. / Stainless steel

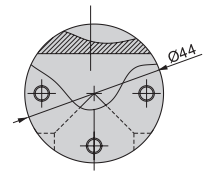
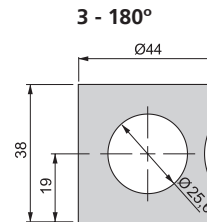
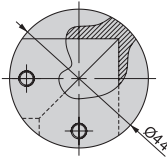
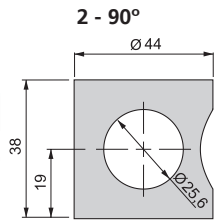

Bisagra Cabina 90x52x2

Cabin Hinger 90x52x2

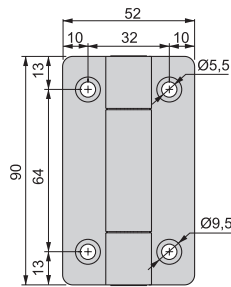

Versión / Version	Cod.		
Con muelle With spring	85005	65	10 / 60
Sin muelle Without spring	85006	65	10 / 60

Acero Inx. / Stainless steel

- Incluye 4 tornillos.
- Include 4 screws.

Bisagra Cabina 65x75x2,5

Cabin Hinger 65x75x2,5

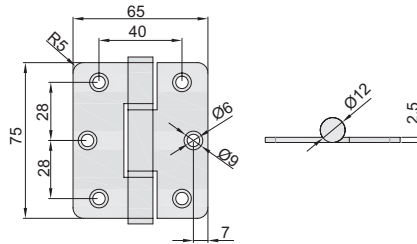

Cod.		
85028	65	10 / 80

Acero Inx. / Stainless steel

- Incluidos tornillos para panel fenólico.
- Screws for phenol board included.

Jgo. Pomos diametro 25

Kit Door Handle Diameter 25

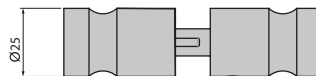

Cod.		
85007	65	10 / 60

Acero Inx. / Stainless steel

- Incluye llave Allen.
- Include hexagonal key.

Condena Plana con Indicador

Door Lock with Indicator

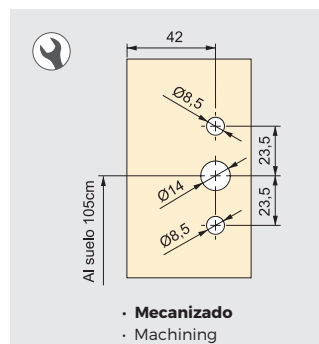

Cod.		
85008	65	1 / 50

Acero Inx. / Stainless steel

- Incluye llave Allen.
- Include hexagonal key.

Condena plana con goma e indicador

Door Lock with rubber and indicator

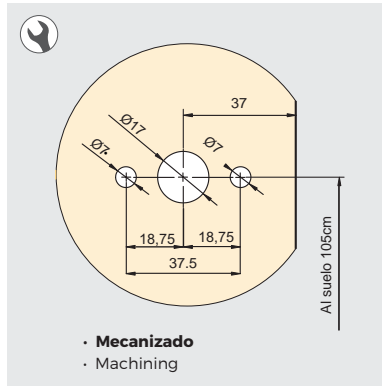

Cod.



85026 65 1 / 40

Acero Inx. / Stainless steel

- Incluye llave Allen.
- Include hexagonal key.

Percha con Tope

Cloths Hanger

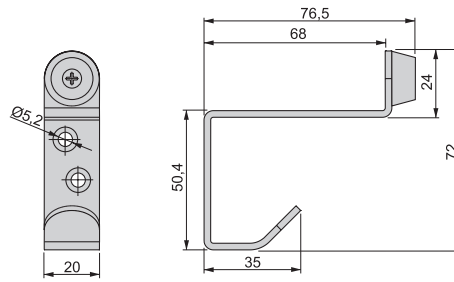

Cod.



85009 65 4 / 80

Acero Inx. / Stainless steel

- Incluye 2 tornillos.
- Include 2 screws.



- Para panel fenólico se recomienda tornillo Cod. 8300865
- For Phenol board it's recommend screw Cod. 8300865

Soporte pared T

Support to wall T

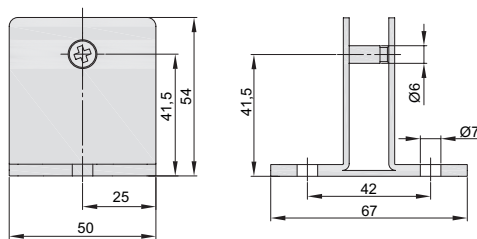

Cod.



85027 65 10 / 80

Acero Inx. / Stainless steel

- Incluye 2 tornillos con tacos.
- Include 2 screws with plastic anchor.

Pinza Union Lateral 50x50

Lateral Support 50x50

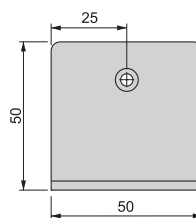

Cod.



85010 65 10 / 100

Acero Inx. / Stainless steel

- Incluye 2 tornillos con tacos.
- Include 2 screws with plastic anchor.

Escuadra de unión lateral 43x43

Corner fastener 43x43

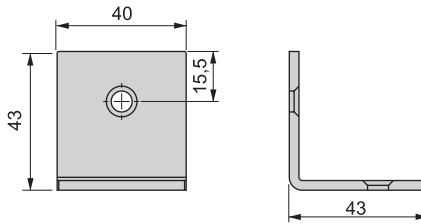

Cod.



85011 | **65** | 10 / 200

Acero Inx. / Stainless steel



• Para panel fenólico se recomienda tornillo Cod. 8300865

• For Phenol board it's recommend screw Cod. 8300865

Perfil L 30x30 Acero Inox

Stainless Steel profile L 30x30

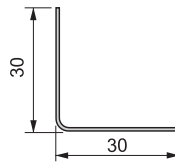

Cod.



1,8 m | **85012** | **65** | 20

Acero Inx. / Stainless steel



• Para panel fenólico se recomienda tornillo Cod. 8300865

• For Phenol board it's recommend screw Cod. 8300865

Perfil U 20x16 Acero Inox

Stainless Steel profile U 20x16

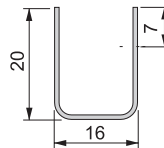

Cod.



1,8 m | **85013** | **65** | 20

Acero Inx. / Stainless steel



• Para panel fenólico se recomienda tornillo Cod. 8300865

• For Phenol board it's recommend screw Cod. 8300865



Tubo Ø25 Acero Inox

Stainless Steel tube Ø25

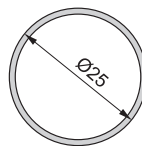

Cod.



2,95 m | **85014** | **65** | 10

Acero Inx. / Stainless steel

Unión Tubo Ø25

Tube union Ø25

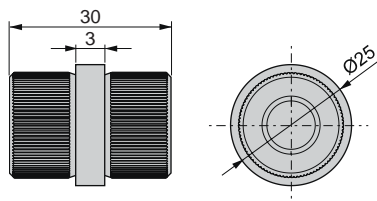

Cod.



85015 | **65** | 20 / 160

Acero Inx. / Stainless steel

PUERTA CORREDERA CABINA SANITARIA / TOILET PARTITION SLIDING DOOR

Sistema Puerta Corredera

Kit Carriage Sliding Door



	Cod.	
1.9 m	85022 62 69	1

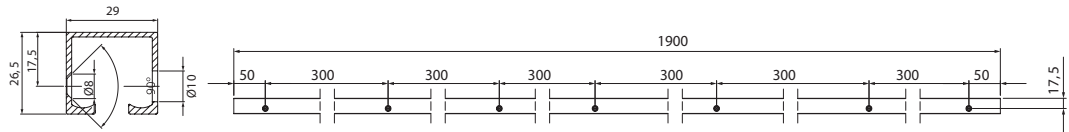
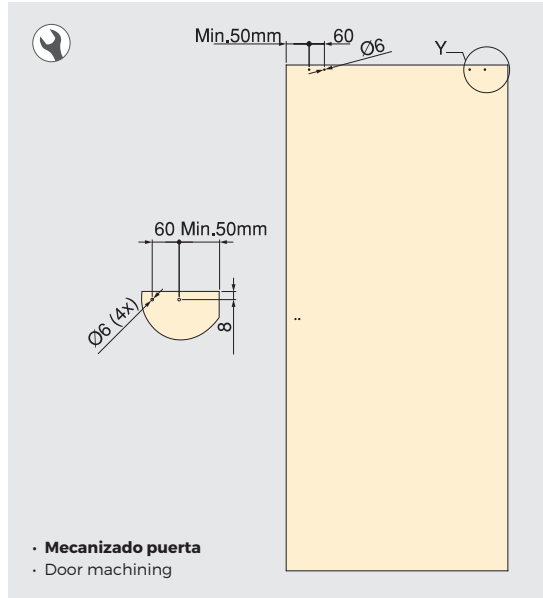

- Perfil se sirve mecanizado.
- Machining included on the profile.

Cierre Suave 50 kg

Soft Closing 50kg



Cod.	
*20905 21	1

Acero y plástico / Steel and plastic

Tuerca remachable M4
Rivetnut M4

Tornillo M4x10
Screw M4x10

POSIBILIDADES MONTAJE GUÍA
TOP TRACK ASSEMBLY

• **Config. perfil remate superior**
• Top Profile config.

• **Config. remate con perfil soporte**
• Support panel profile config.

• **Config. fijación con pinza**
• Hanging clamp config.

Hoja de Pedido Perfil Remate superior

Top Profile Data Sheet

Apertura izquierdas / Left opening

Apertura derechas / Right opening

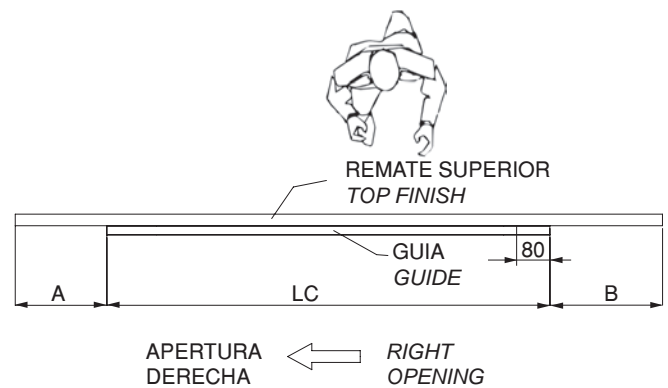
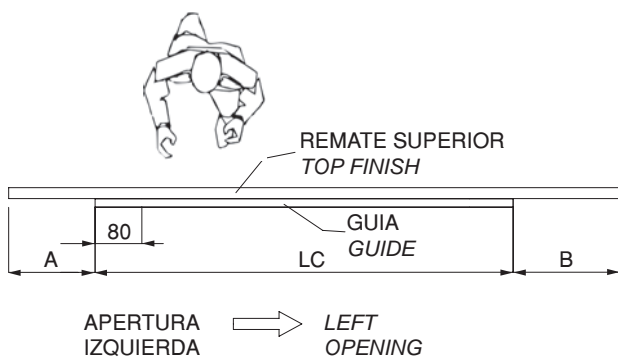
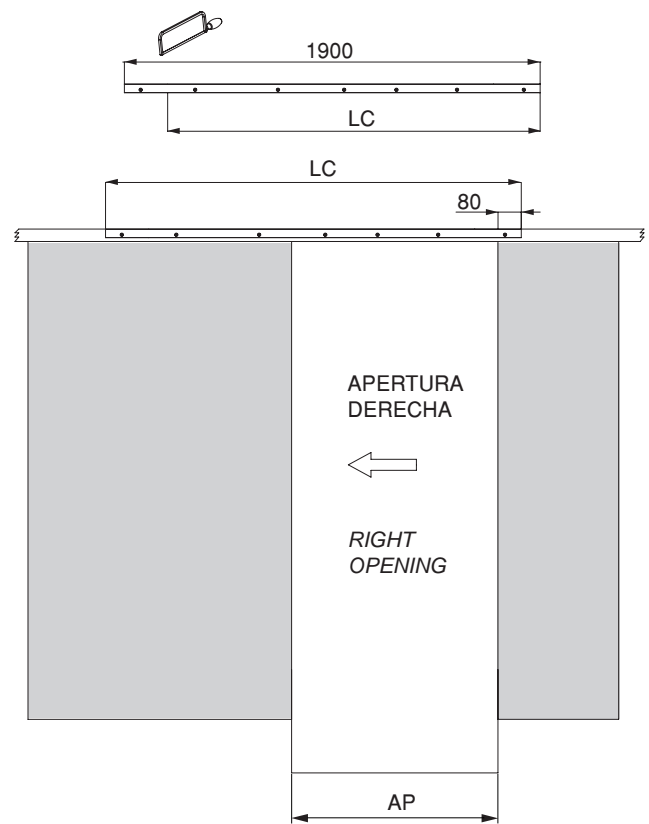
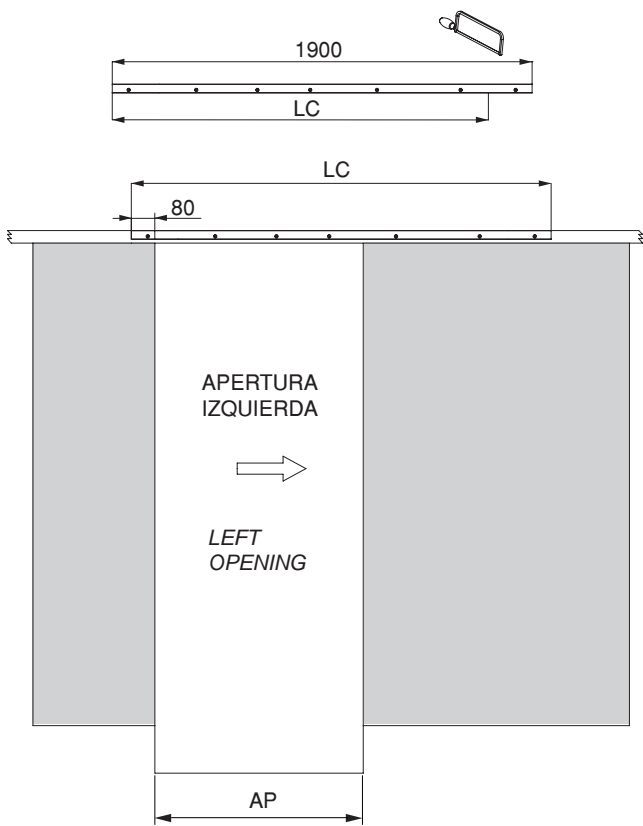

	L	LC	A	B	AP
Medidas Measurements					

	L	LC	A	B	AP
Medidas Measurements					

L= Longitud remate superior
 L= Top profile length

LC = Longitud de corte
 LC= Cutting Length

AP= Ancho hueco
 AP= Overall width

Juego Condena Puerta Corredera con Tirador

Sliding Door Kit Lock With Indicator

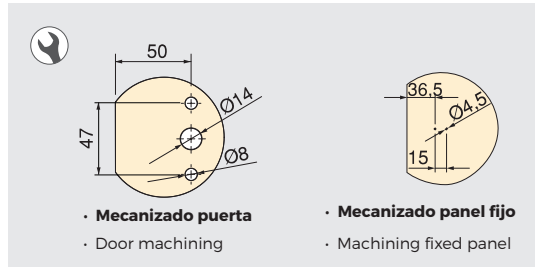

Cod.



85019 65 1 / 50

Acero Inx. y zamak /
Stainless steel and Zamak



Distanciador para Condena

Door Lock Distancing

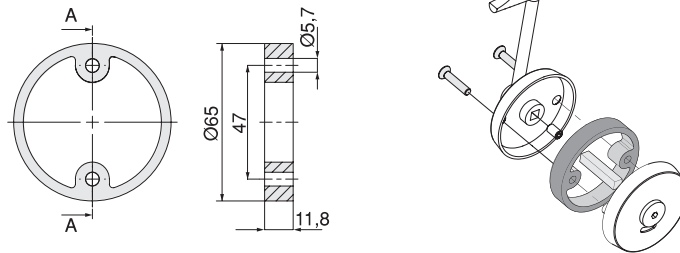

Cod.



85020 65 5 / 150

Zamak / Zamak

Condena Puerta Corredera

Sliding Door Lock With Indicator

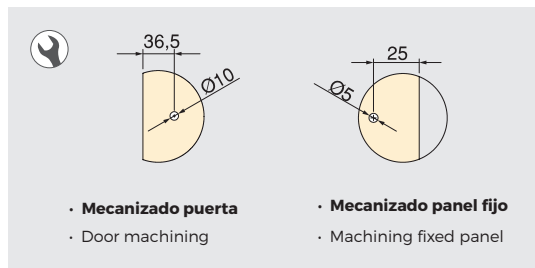

Cod.



85024 65 1 / 40

Acero Inx. / Stainless steel



Juego de puerta corredera

Kit sliding door

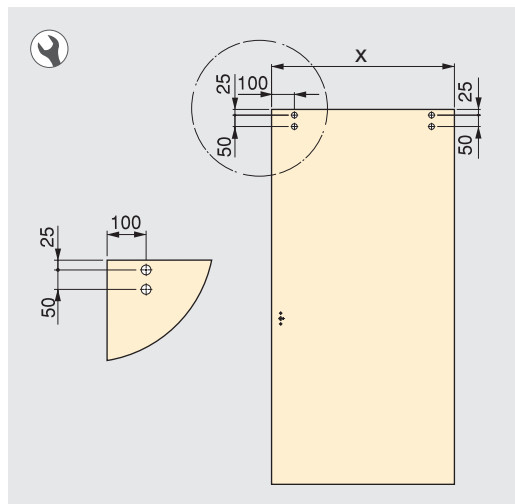

Cod.



85016 65 1 / 5

Acero Inx. / Stainless steel



PERFILES DE ALUMINIO PARA CABINAS SANITARIAS / ALUMINIUM PROFILES FOR TOILET PARTITION FITTINGS

Per. Cantonera 90° 30x30 Al Inx Sat

Profile connector 90° 30x30 Al Inx Sat

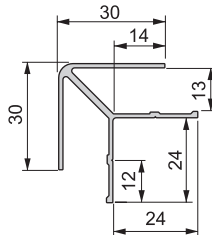
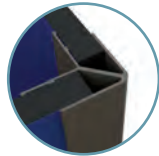

	Cod.			
1,85 m	83014	62	69	8
⊙ _m	83001	62	69	E/I

Aluminio / Aluminium

- Montaje sin tornillos en la cara exterior.
- Assembly without screws on the external face.

Perfil Soporte Panel Al Inx Sat

Support panel profile Al Inx Sat

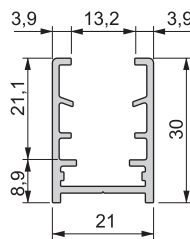
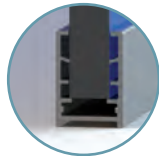

	Cod.			
1,85 m	83023	62	69	8
2,95 m	83002	62	69	8
⊙ _m	83003	62	69	E/I

Aluminio / Aluminium

Perfil Soporte "U" Al

Support profile "U" Al

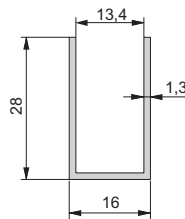

	Cod.			
1,85 m	83035	62	-	8
2,95 m	83036	62	-	8

Aluminio / Aluminium

Perfil Remate Superior Al Inx Sat

Top Profile Al Inx Sat

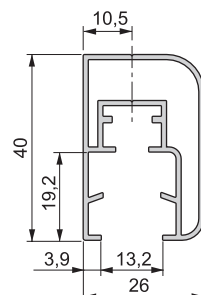

	Cod.			
2,95 m	83004	62	69	8
⊙ _m	83005	62	69	E/I

Aluminio / Aluminium

- Posibilidad de unión a inglete con Escuadra Cod. 8300720
- Possibility miter joint with Bracket Cod. 8300720

E/I: Embalaje adaptado al pedido.
 E/I: Packaging adapted to the order.

⊙_m Corte a medida
 Cut to measure

Escuadra Remate Sup.

Top Profile Bracket

Cod.  

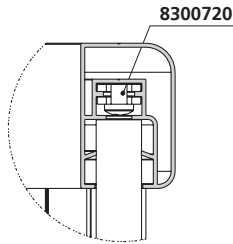

***83007** 20 1/40

Acero / Steel



Tornillo Pasante M5 Avellanado

Set Through Screw M5 Flat head

X	Y	Cod. 	
8	12	83030 65	500 / 5.000
12	18	83037 65	100 / 2.000

Acero Inx. / Stainless steel

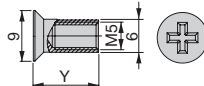
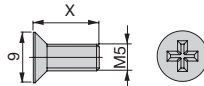

- Cod. 8303765 - Repuesto del tornillo de las Patas Regulables.
- Cod. 8303765 - Spare part for the screw of Adjustable Legs.

Tornillo Pasante M5 Alomado

Set Through Screw M5 Round head

Cod.  

83031 65 500 / 5.000

Acero Inx. / Stainless steel

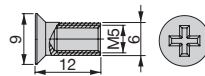
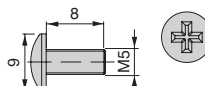

Tornillo Cabeza Redonda Inox

Roundhead Screw Inx

Ø	D	L	Cod. 	
3.5	6.9	9.5	83008 65	1.000
4.2	8.2	9.5	83009 65	1.000

Acero Inx. / Stainless steel

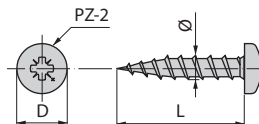

- **Tornillo recomendado para la fijación de panel fenólico**
- Screw recommended for the fixation of phenolic board

HERRAJES PARA TAQUILLAS / LOCKER FITTINGS

Perfil Taquilla

Locker Profile

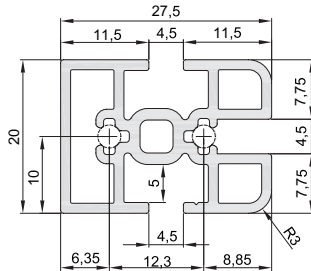

	Cod.	
1,8 m	83033 62	8
	83032 62	E/I

Aluminio / Aluminium

- Bisagra recomendada Cod.8303465
- Recommended hinge Cod.8303465



Permite la realización de taquillas con fenólico de 4mm de espesor.

Allow lockers with phenolic 4mm thickness.

E/I: Embalaje adaptado al pedido.

E/I: Packaging adapted to the order.

Kit Bisagra Inx. Taquilla

kit Locker Hinge Inx.

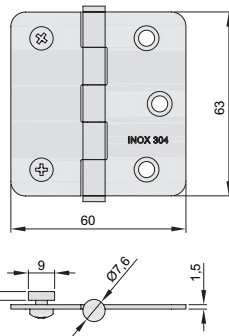

Cod.



83034 **65** 2 / 160

Acero Inx. / Stainless steel

- Embalaje bolsa de 2 juegos.
- Packaging plastic bag with 2 set.

Escuadra Soporte Estante

Shelf Support



x 50

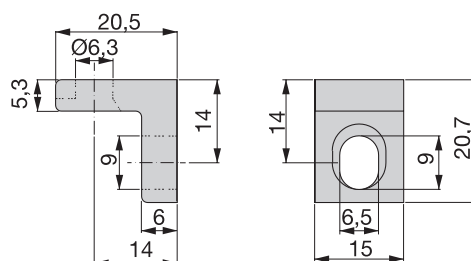

Cod.



40209 **07** 1 / 20

Zamak / Zamak

- Caja de 50 uds. / Caja Master: 20 cajas de 50 uds.
- Box with 50 units / Masterbox: 20 Boxes of 50 units.

Corte a medida
 Cut to measure

Cerradura CODE

CODE lock



Imagen Mano izq / Image Left Hand

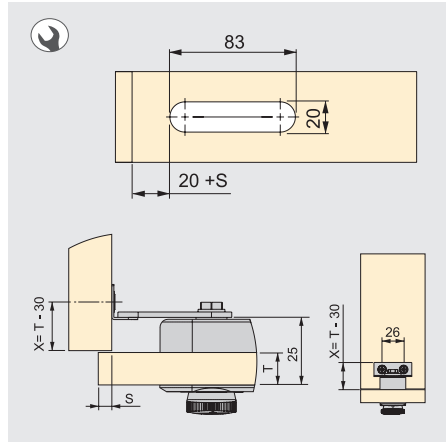

Mano Hand		Cod.	
der / right	4 - 12	80500	14 E/I
izq / left	4 - 12	80501	14 E/I

Acero y plástico / Steel and plastic

- Cada pedido incluye una llave de mantenimiento Cod. 8050405
- Each order includes one maintenance key Cod. 8050405

Cerradura CODE para madera

CODE lock for wood



Imagen Mano izq / Image Left Hand

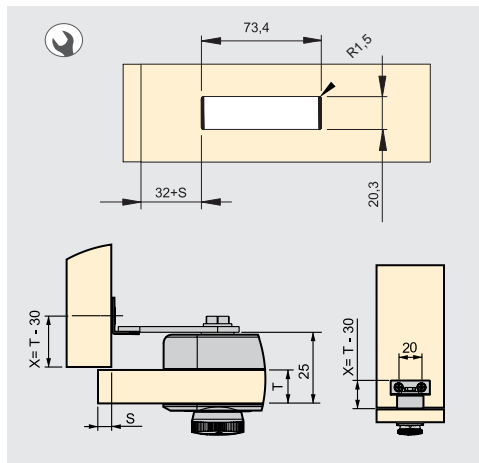

Mano Hand		Cod.	
der / right	4 - 12	80502	14 E/I
izq / left	4 - 12	80503	14 E/I

Acero y plástico / Steel and plastic

- Cada pedido incluye una llave de mantenimiento
- Each order includes one maintenance key

Cerradura 2651

Lock 2651

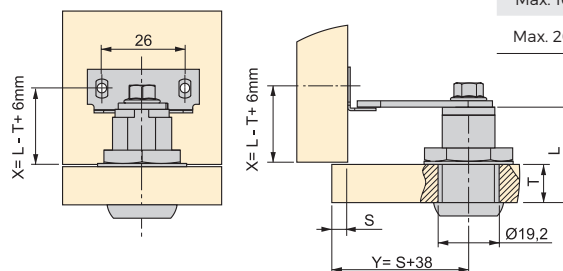

T	L	Cod.	
Max. 16mm	25	83020	07 E/I
Max. 20mm	30	83021	07 E/I

Acero / Steel

- S: Solape.
- S: Overlay.

Escuadra cerradura 2651

Lock square 2651



Cod.	
83012	07 E/I

Acero / Steel

E/I: Embalaje adaptado al pedido.
 E/I: Packaging adapted to the order.

Llave maestra azul

Blue Master Key



- Para cerradura 2651.
- For lock 2651.

Cod.



70109	20	E/I
--------------	-----------	-----

Latón y Plástico
 Brass and Plastic

Cerradura candado Ø8 CRO

Padlock 8mm diameter CRO

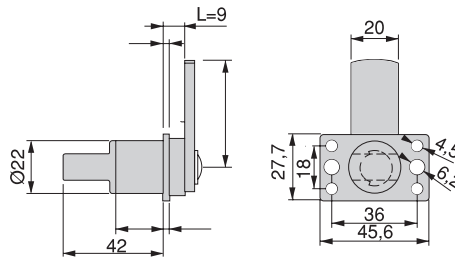

Mano
 Hand

Cod.



der / right	83027	11	E/I
izq / left	83028	11	E/I

Zamak y acero
 Zamak and Steel

- Candado arco Ø8mm.
- 60.000 ciclos según directrices LGA
- For lock Ø8mm.
- 60.000 cycles according to directives LGA

Cerradura Moneda

Lock Coin

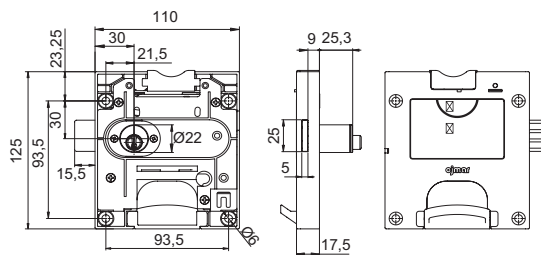

Mano
 Hand

Cod.



der / right	83017	14	5
izq / left	83018	14	5

Zamak y Plástico
 Zamak and Plastic

Escuadra Cerradura Moneda

Lock Coin Square

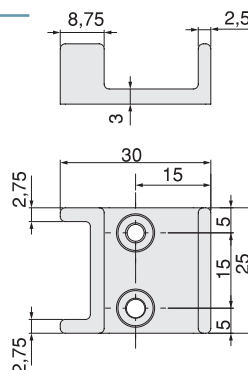

Cod.



83019	51	E/I
--------------	-----------	-----

Zamak / Zamak

E/I: Embalaje adaptado al pedido.
 E/I: Packaging adapted to the order.

COMPLEMENTOS PARA TAQUILLA / ACCESSORIES FOR LOCKER

Tubo de acero

Steel rail

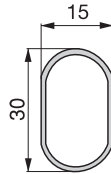
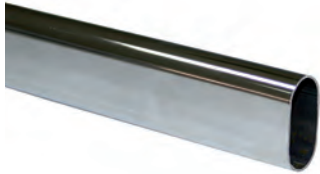

	Cod.	
2.35 m	70094 11	10
Acero / Steel		

Soporte lateral

Lateral support

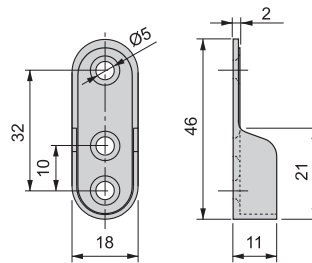

Cod.	
40070 07	500
Acero / Steel	

Soporte antivandálico

Anti-vandal support

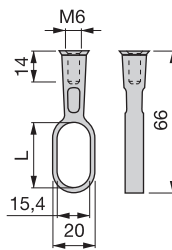

L	Cod.	
30	81203 25	500
Zamak / Zamak		

Tornillo M6

M6 screw

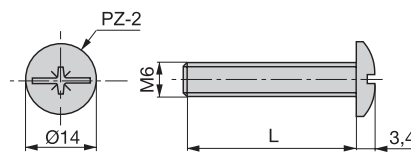

L	Cod.	
20	50221 07	2.000
Acero / Steel		

- Tornillo recomendado Cod. 5022107
- Screw recommend Cod. 5022107



PIES PARA TAQUILLAS / FEET PARTITION HARDWARE

Pie 100-150

Foot 100-150

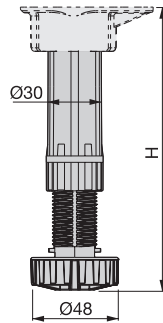

Altura Zócalo Altura Rodapé	H	Cod.		
100 - 120	98 - 140	39118	17	200
120 - 150	118 - 160	39119	17	200

Plástico / Plastic

Base montaje mediante Tornillo

Screw mounting base

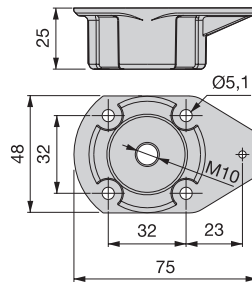

Cod.



39121 **17** 200

Plástico / Plastic

Pinza para zocalos montaje directo/tornillo

Direct-screw mounting clip for plinth

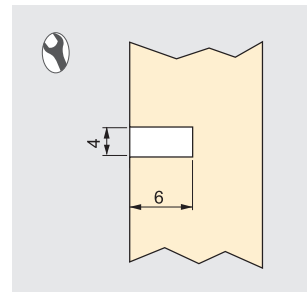
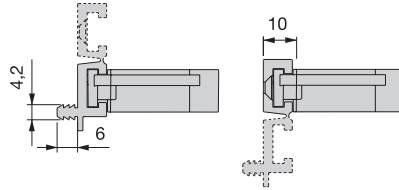

Cod.



39129 **17** 200

Plástico / Plastic

Tornillo M10

M10 screw

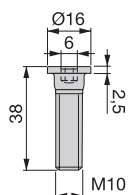

Cod.



39126 **05** 200

Acero / Steel

Nivelador M6 hexagonal

M6 hexagonal leveller

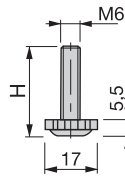

H	Cod.		
15	30520	17	1250
20	30499	05	1000

Acero y plástico
Steel and plastic

Nivelador M6 circular

M6 circular leveller

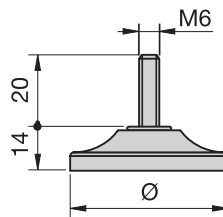

Ø	Cod.		
35	30809	25	100 / 500

Acero / Steel

Nivelador M10 circular

M10 circular leveller

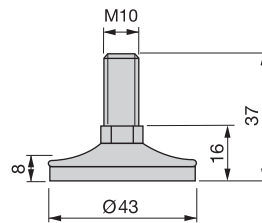

Cod.			
30574	64	100 / 500	

Acero y plástico
Steel and plastic



NOTAS





